



\* required information

**Section 1 of 17**

You can save the form at any time and resume it later. You do not need to be logged in when you resume.

System reference

Not Currently In Use

This is the unique reference for this application generated by the system.

Your reference

Bierkeller V.1

You can put what you want here to help you track applications if you make lots of them. It is passed to the authority.

Are you an agent acting on behalf of the applicant?

- Yes  No

Put "no" if you are applying on your own behalf or on behalf of a business you own or work for.

**Applicant Details**

\* First name

\* Family name

\* E-mail

Main telephone number

Include country code.

Other telephone number

Indicate here if you work

Are you:

- Applying as a business or organisation, including as a sole trader  
 Applying as an individual

A sole trader is a business owned by one person without any special legal structure. Applying as an individual means you are applying so you can be employed, or for some other personal reason, such as following a hobby.

**Applicant Business**

\* Is your business registered in the UK with Companies House?

- Yes  No

\* Is your business registered outside the UK?

- Yes  No

\* Business name

None The Bierkeller (Torquay) LTD

If your business is registered, use its registered name.

\* VAT number

-

Put "none" if you are not registered for VAT.

\* Legal status

Private Limited Company

Continued from previous page...

Non-domestic rateable  
value of premises (£)

### Section 3 of 17

#### VARIATION

Do you want the proposed  
variation to have effect as  
soon as possible?

Yes  No

Do you want the proposed variation to have effect in relation to the  
introduction of the late night levy?

Yes  No

You do not have to pay a fee if the only  
purpose of the variation for which you are  
applying is to avoid becoming liable to the  
late night levy.

If your proposed variation  
would mean that 5,000 or  
more people are expected to  
attend the premises at any  
one time, state the number  
expected to attend

#### Describe Briefly The Nature Of The Proposed Variation

Describe the premises. For example the type of premises, its general situation and layout and any other information which could be relevant to the licensing objectives. Where your application includes off-supplies of alcohol and you intend to provide a place for consumption of these off-supplies, you must include a description of where the place will be and its proximity to the premises.

To remove a condition under the prevention of crime and disorder relating to alcohol only being consumed with food and whilst seated. To remove a condition under the prevention of public nuisance in relation to the stage. To remove the wording for live music under the standard timings which states music can only be played on the stage at the rear of the premises'. *Change of plan of premises to show new stage location.*

### Section 4 of 17

#### PROVISION OF PLAYS

Will the schedule to provide plays be subject to change if this application to  
vary is successful?

Yes  No

### Section 5 of 17

#### PROVISION OF FILMS

Will the schedule to provide films be subject to change if this application to  
vary is successful?

Yes  No

### Section 6 of 17

#### PROVISION OF INDOOR SPORTING EVENTS

Will the schedule to provide indoor sporting events be subject to change if  
this application to vary is successful?

**Section 7 of 17**

**PROVISION OF BOXING OR WRESTLING ENTERTAINMENTS**

Will the schedule to provide boxing or wrestling entertainments be subject to change if this application to vary is successful?  
 Yes  No

**Section 8 of 17**

**PROVISION OF LIVE MUSIC**

Will the schedule to provide live music be subject to change if this application to vary is successful?  
 Yes  No

**Section 9 of 17**

**PROVISION OF RECORDED MUSIC**

Will the schedule to provide recorded music be subject to change if this application to vary is successful?  
 Yes  No

**Section 10 of 17**

**PROVISION OF PERFORMANCES OF DANCE**

Will the schedule to provide performances of dance be subject to change if this application to vary is successful?  
 Yes  No

**Section 11 of 17**

**PROVISION OF ANYTHING OF A SIMILAR DESCRIPTION TO LIVE MUSIC, RECORDED MUSIC OR PERFORMANCES OF DANCE**

Will the schedule to provide anything similar to live music, recorded music or performances of dance be subject to change if this application to vary is successful?  
 Yes  No

**Section 12 of 17**

**PROVISION OF LATE NIGHT REFRESHMENT**

Will the schedule to provide late night refreshment be subject to change if this application to vary is successful?  
 Yes  No

**Section 13 of 17**

**SUPPLY OF ALCOHOL**

Will the schedule to supply alcohol be subject to change if this application to vary is successful?  
 Yes  No

Continued from previous page...

**Section 14 of 17**

**ADULT ENTERTAINMENT**

Highlight any adult entertainment or services, activities, or other entertainment or matters ancillary to the use of the premises that may give rise to concern in respect of children.

Provide information about anything intended to occur at the premises or ancillary to the use of the premises which may give rise to concern in respect of children, regardless of whether you intend children to have access to the premises, for example (but not exclusively) nudity or semi-nudity, films for restricted age groups etc gambling machines etc.

**Section 15 of 17**

**HOURS PREMISES ARE OPEN TO THE PUBLIC**

**Standard Days And Timings**

MONDAY

Start

End

Start

End

Provide timings in 24 hour clock (e.g., 16:00) and only give details for the days of the week when you intend the premises to be used for the activity.

TUESDAY

Start

End

Start

End

WEDNESDAY

Start

End

Start

End

THURSDAY

Start

End

Start

End

FRIDAY

Start

End

Start

End

SATURDAY

Start

End

Start

End

SUNDAY

Start

End

Start

End

State any seasonal variations.

*Continued from previous page...*

For example (but not exclusively) where the activity will occur on additional days during the summer months.

Non standard timings. Where you intend to use the premises to be open to the members and guests at different times from those listed above, list below.

For example (but not exclusively), where you wish the activity to go on longer on a particular day e.g. Christmas Eve.

Identify those conditions currently imposed on the licence which you believe could be removed as a consequence of the proposed variation you are seeking.

Annexe 2 – Crime and Disorder – Condition 1 and Annexe 2 – Public Nuisance – Condition 3'

- I have enclosed the premises licence
- I have enclosed the relevant part of the premises licence

Reasons why I have failed to enclose the premises licence or relevant part of premises licence.

**Section 16 of 17**

**LICENSING OBJECTIVES**

Describe the steps you intend to take to promote the four licensing objectives:

a) General – all four licensing objectives (b,c,d,e)

List here steps you will take to promote all four licensing objectives together.

b) The prevention of crime and disorder

Substantial food to be available between the hours of 11.00 and 21.00

Continued from previous page...

c) Public safety

d) The prevention of public nuisance

e) The protection of children from harm

## Section 17 of 17

### PAYMENT DETAILS

This fee must be paid to the authority. If you complete the application online, you must pay it by debit or credit card.

Variation Fees are determined by the non-domestic rateable value of the premises.

To find out a premises non domestic rateable value go to the Valuation Office Agency site at [http://www.voa.gov.uk/business\\_rates/index.htm](http://www.voa.gov.uk/business_rates/index.htm)

Band A - No RV to £4300 £100.00

Band B - £4301 to £33000 £190.00

Band C - £33001 to £87000 £315.00

Band D - £87001 to £125000 £450.00\*

Band E - £125001 and over £635.00\*

\*If the premises rateable value is in Bands D or E and the premises is primarily used for the consumption of alcohol on the premises then you are required to pay a higher fee

Band D - £87001 to £125000 £900.00

Band E - £125001 and over £1,905.00

If you own a large premise you are subject to additional fees based upon the number in attendance at any one time

Capacity 5000-9999 £1,000.00

Capacity 10000 -14999 £2,000.00

Capacity 15000-19999 £4,000.00

Capacity 20000-29999 £8,000.00

Capacity 30000-39000 £16,000.00

Capacity 40000-49999 £24,000.00

Capacity 50000-59999 £32,000.00

Capacity 60000-69999 £40,000.00

Capacity 70000-79999 £48,000.00

Capacity 80000-89999 £56,000.00

Capacity 90000 and over £64,000.00

\* Fee amount (£)

190.00

### ATTACHMENTS

### AUTHORITY POSTAL ADDRESS

# ANNEXE 4

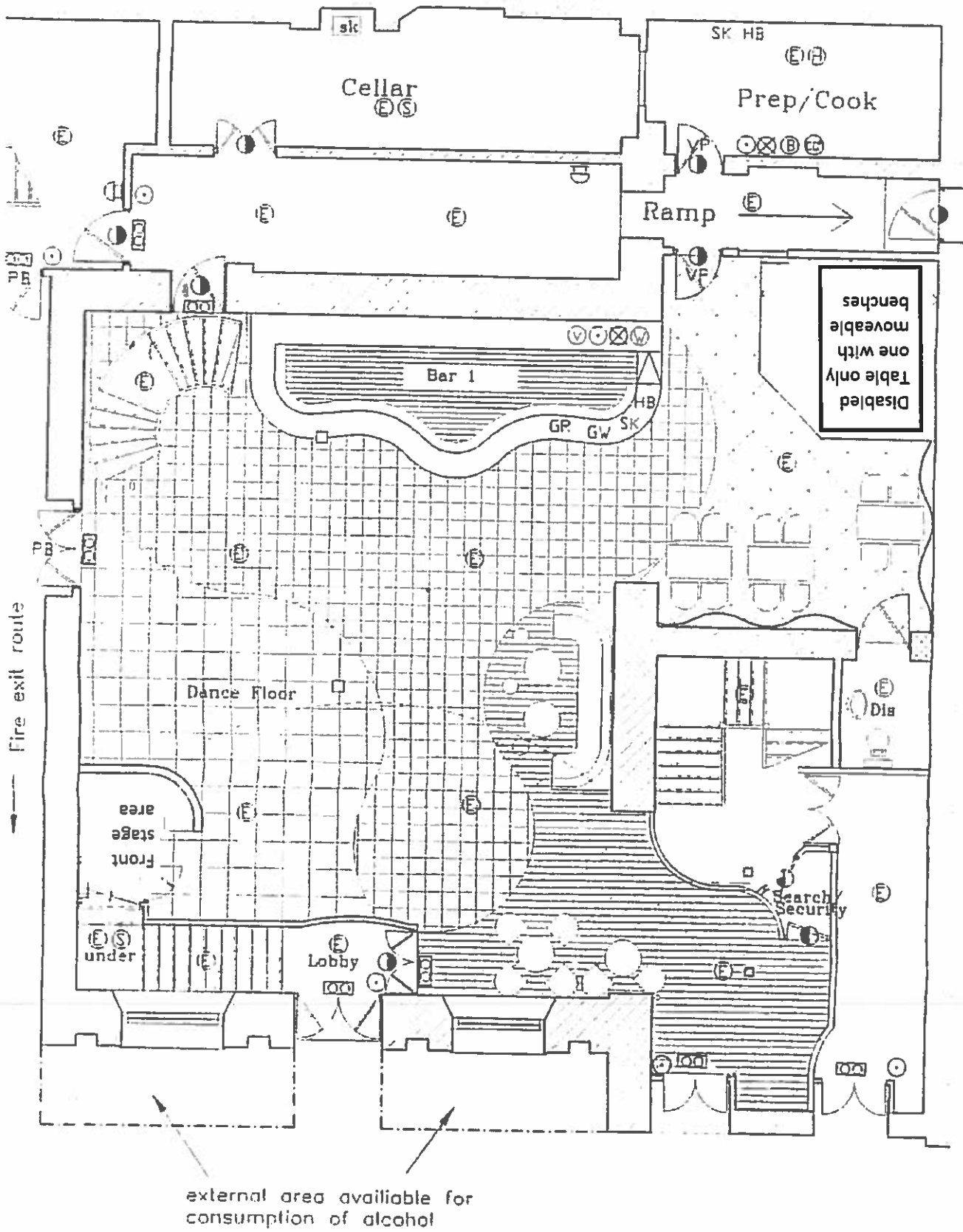

GROUND FLOOR